

| | | |
|--|--------------|--|
| Nominal Voltage | | 12 V |
| Number of cell | | 6 cells |
| Capacity(20HR, 25°C) | | 18 Ah |
| Capacity(15min.rate, 25°C) | | 76 Watts/cell |
| Dimension | Length | 181 ± 2mm (7.13inch) |
| | Width | 77 ± 1mm (3.03inch) |
| | Height | 167 ± 2mm (6.57inch) |
| | Total Height | 167 ± 2mm (6.57inch) |
| Approx. Weight | | 5.7kg (12.6lbs) ± 4% |
| Terminal type | | T3/T8 |
| Internal resistance (Fully charged, 25°C) | | Approx. 12m Ω |
| Capacity affected by temperature (20HR) | 40°C | 102% |
| | 25°C | 100% |
| | 0°C | 85% |
| | -15°C | 65% |
| Self-discharge (25°C) | 3 month | Remaining Capacity: 91% |
| | 6 month | Remaining Capacity: 82% |
| | 12 month | Remaining Capacity: 65% |
| Nominal operating temperature | | 25°C ± 3°C (77°F ± 5°F) |
| Operating temperature range | Discharge | -15°C ~ 50°C (5°F ~ 122°F) |
| | Charge | -10°C ~ 50°C (14°F ~ 122°F) |
| | Storage | -20°C ~ 50°C (-4°F ~ 122°F) |
| Float charging voltage(25°C) | | 13.60 to 13.80V Temperature compensation: -18mV/°C |
| Cyclic charging voltage(25°C) | | 14.50 to 14.90V Temperature compensation: -30mV/°C |
| Maximum charging current | | 5.4A |
| Terminal material | | Copper |
| Maximum discharge current | | 270A(5 sec.) |
| Designed floating life(20°C) | | 3~5 years |

- ◆ Absorbent glass mat technology;
- ◆ Recognized by UL & CE;
- ◆ ABS container.

Dimensions

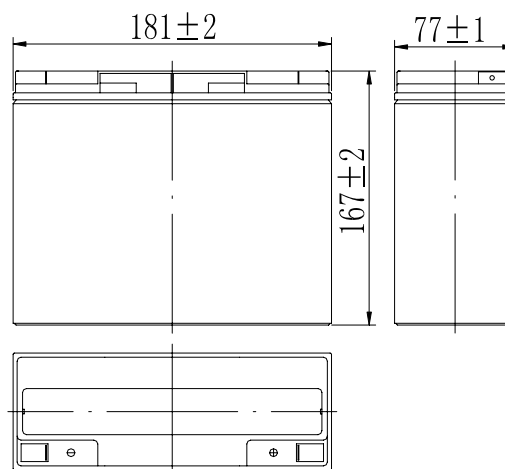

Terminal

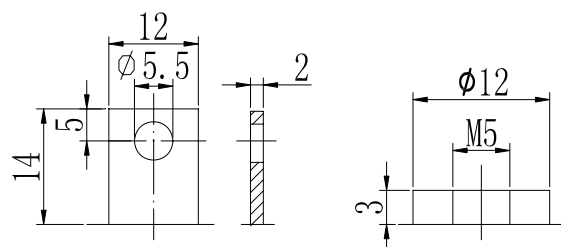

Terminal T3

Terminal T8

Constant Current Discharge Characteristics (A, 25°C)

| F.V/TIME | 10min | 15min | 20min | 30min | 45min | 60min | 2h | 3h | 5h | 10h | 20h |
|------------|-------|-------|-------|-------|-------|-------|------|------|------|------|------|
| 1.60V/cell | 51.0 | 40.2 | 31.9 | 22.1 | 15.8 | 12.5 | 6.58 | 4.68 | 3.21 | 1.74 | 0.93 |
| 1.65V/cell | 49.5 | 39.2 | 31.1 | 21.6 | 15.5 | 12.3 | 6.54 | 4.65 | 3.19 | 1.73 | 0.93 |
| 1.67V/cell | 48.7 | 38.6 | 30.6 | 21.4 | 15.3 | 12.2 | 6.52 | 4.64 | 3.18 | 1.73 | 0.93 |
| 1.70V/cell | 47.5 | 37.8 | 30.0 | 21.0 | 15.0 | 12.0 | 6.48 | 4.62 | 3.17 | 1.72 | 0.92 |
| 1.75V/cell | 45.4 | 36.5 | 28.9 | 20.5 | 14.7 | 11.8 | 6.38 | 4.59 | 3.15 | 1.71 | 0.92 |
| 1.80V/cell | 42.9 | 34.6 | 27.4 | 19.7 | 14.1 | 11.4 | 6.22 | 4.45 | 3.06 | 1.68 | 0.90 |

Constant Power Discharge Characteristics (Watt/cell, 25°C)

| F.V/TIME | 10min | 15min | 20min | 30min | 45min | 60min | 2h | 3h | 5h | 10h | 20h |
|------------|-------|-------|-------|-------|-------|-------|------|------|------|------|------|
| 1.60V/cell | 98.5 | 79.2 | 62.8 | 43.5 | 31.2 | 24.6 | 13.0 | 9.36 | 6.43 | 3.47 | 1.86 |
| 1.65V/cell | 95.5 | 77.3 | 61.3 | 42.6 | 30.6 | 24.2 | 12.9 | 9.31 | 6.39 | 3.46 | 1.86 |
| 1.67V/cell | 94.0 | 76.0 | 60.3 | 42.1 | 30.2 | 24.0 | 12.9 | 9.28 | 6.37 | 3.45 | 1.85 |
| 1.70V/cell | 91.6 | 74.4 | 59.0 | 41.3 | 29.6 | 23.6 | 12.8 | 9.24 | 6.34 | 3.44 | 1.85 |
| 1.75V/cell | 87.6 | 71.9 | 57.0 | 40.3 | 28.9 | 23.2 | 12.6 | 9.18 | 6.30 | 3.42 | 1.84 |
| 1.80V/cell | 82.7 | 68.1 | 54.0 | 38.8 | 27.8 | 22.5 | 12.3 | 8.90 | 6.11 | 3.35 | 1.80 |

Note: The above characteristics data can be obtained within three charge/discharge cycles.

Discharge Characteristics(25°C)

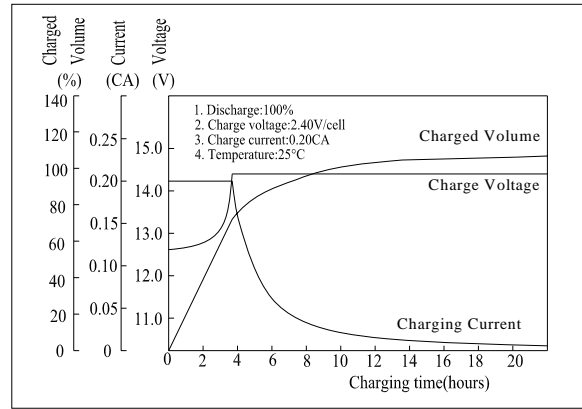
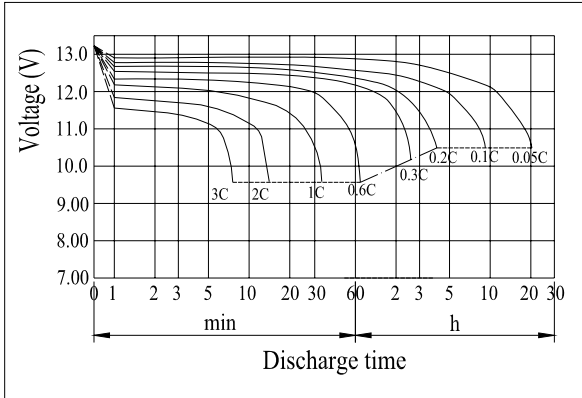

Self-discharge Characteristics

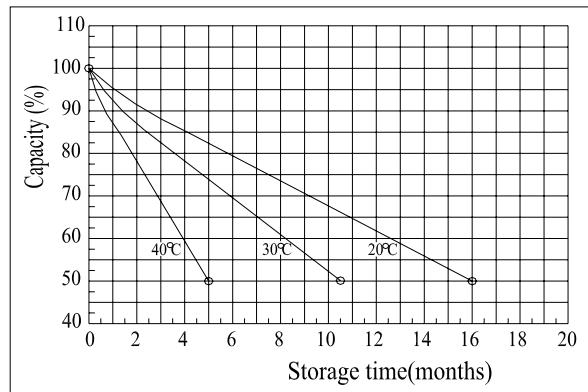

Effect of Temperature on Capacity

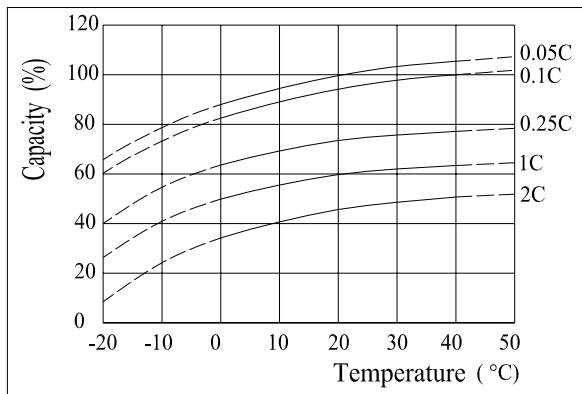

The Relationship for Charging Voltage and Temperature

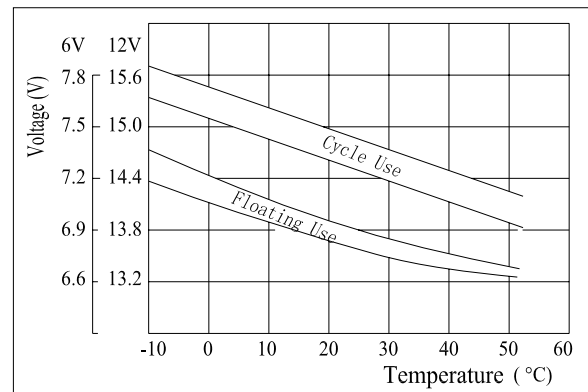

The Relationship for Open Circuit Voltage and Residual Capacity (25°C)

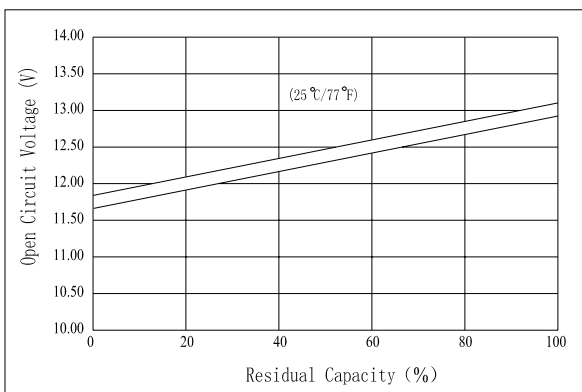

Cycle Life on D.O.D(25°C)

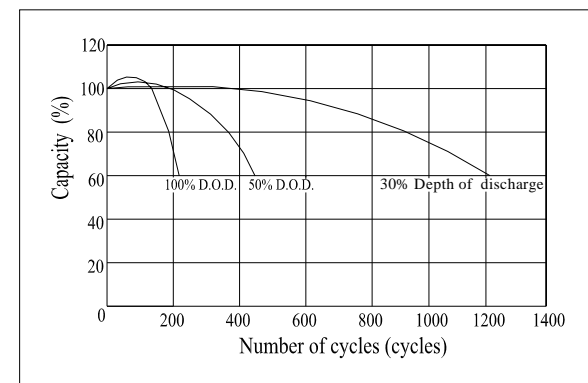

Floating Life on Temperature

